



2100 E. Richmond Ave
Fort Worth, TX 76104
Call: 817.926.7270
Fax: 817.926.7311
www.arch-fab.com

MODEL: STANDING SEAM AWNING

Aluminum Tube Frame with Standing Seam Panels

Information is subject to change. Updated 3/29/2019

Application

Architectural Fabrication, Inc. Standing Seam Awning are designed to provide a unique architectural feel to the exterior appearance of a building while providing rain and sun protection. All of our Standing Seam Awning have many customizable options to best suit your project.

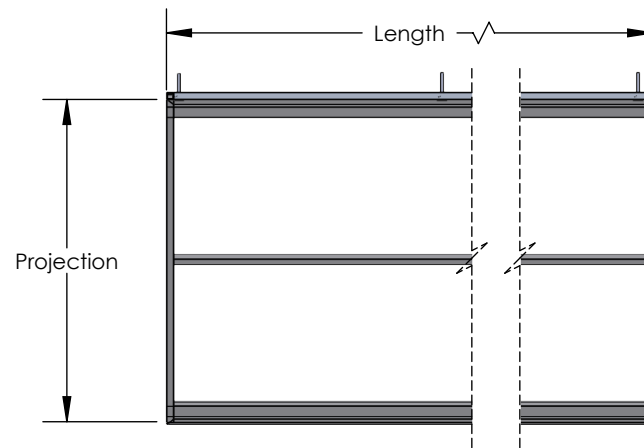
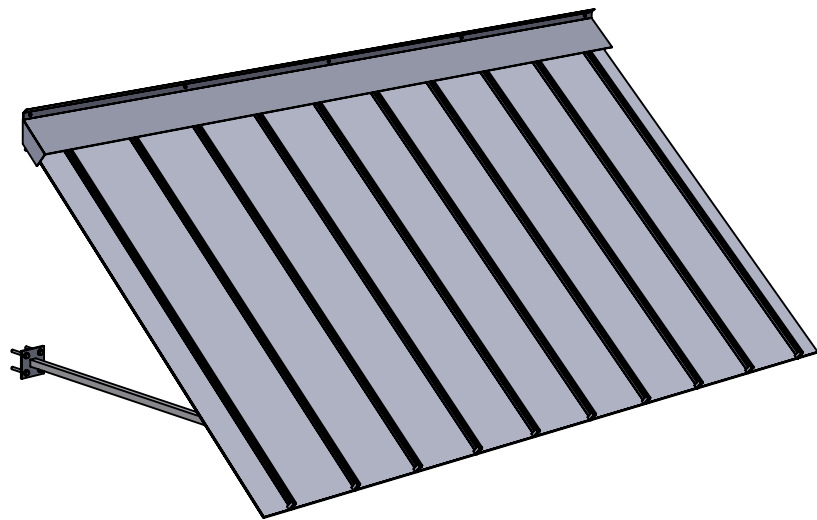

STANDARD PLAN VIEW

Standing Seam Panels removed for clarity.
Standing Seam Panels will overhang front & sides of frame 1 1/2".

STANDING SEAM AWNING STANDARD CONSTRUCTION

- Material: 6063 - T5 Extruded Aluminum
- Fabrication Method: Welded & Mechanically Fastened
- Frame: 1" X 1" X .093 Aluminum Tube (Typ.)
- Cover: Standing Seam Panels (panels will overhang front & sides 1 1/2") (soffit panels are available)
- Fascia Profile: With or Without Valance
- Projection: 12"- 144"
- Length: Single unit up to 288", Multiple units unlimited
- Mounting: Exposed
- Outside Ends: Open or Closed
- Brackets: 1" Z-Clip (Typ.)
- Flashing: Surface Mount with Sealant
- If slope is greater than 36°, additional framing will be required.

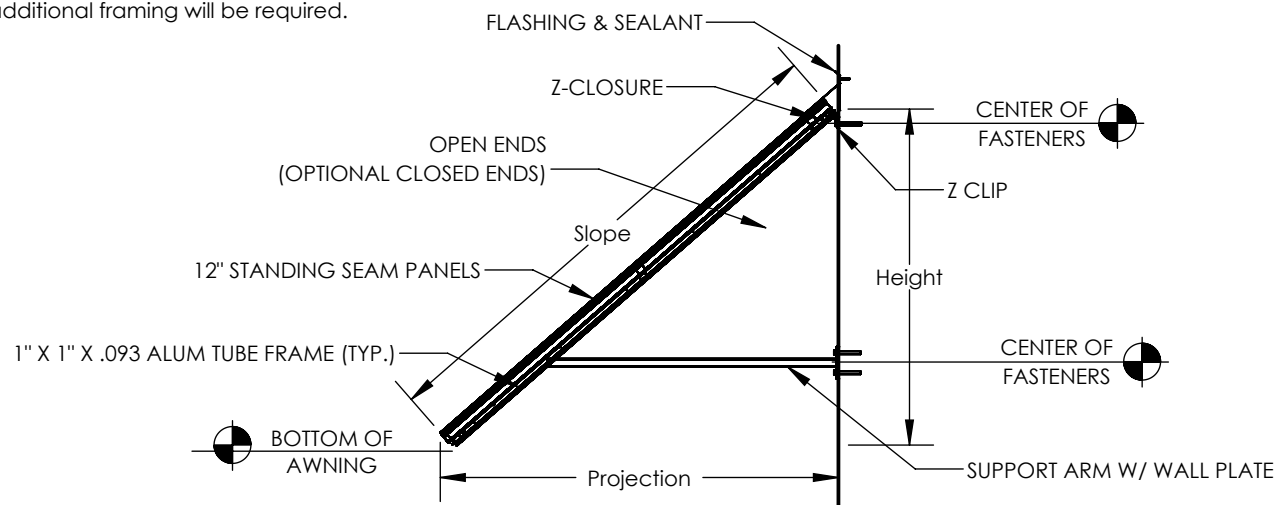

HORIZONTAL SECTION

FRAME FINISH STANDARD POWDER COAT COLORS

Colors represented in this brochure are indicative only. Actual powder coat colors may vary.



DECK FINISH STANDARD BERRIDGE PANEL COLORS

Underside of panels will be wash coat.
Colors represented in this brochure are indicative only. Actual colors may vary.

